

ATTACHMENT A

**DEVELOPED DESIGN FOR CROWN
CLEVELAND AND BAPTIST STREET
AS EXHIBITED**

ABOUT THE PROJECT

- Wider footpaths on both sides of Crown Street between Devonshire and Cleveland Streets to create more pedestrian space and opportunities for outdoor dining;
- New kerbs and paving, street furniture, seven more trees and landscaping;
- Improving lighting by adding 13 Smartpoles and moving overhead power lines underground to reduce clutter at the at the Cleveland, Crown and Baptist intersection;
- A continuous paved footpath along Crown Street across Miles and Lansdowne Streets;
- A raised pedestrian crossing on Crown Street north of Lansdowne Street to replace the two speed humps;
- Combining two city-bound bus stops located outside Commonwealth Bank and 513 Crown Street into one stop at 525 Crown Street (Surry Cutters, near Miles Street);
- Moving the southbound bus stop at 586 Crown Street (outside Special Lights) to 614/616 Crown Street, south of the new raised crossing;
- Realigning traffic signals at the Cleveland, Crown and Baptist Streets intersection and removing the slip lane at Baptist Street to improve pedestrian flow;
- New paving and garden beds along Baptist Street from the NSW Mounted Police to Boronia Lane in line with works recently completed in the street;
- New paving and public art along the Crown to Wilshire Street pedestrian link; and
- Standardising parking times, with 2P parking from 8am–6pm, 4P from 6pm–10pm and 10am–10pm on Saturdays, Sundays and public holidays.

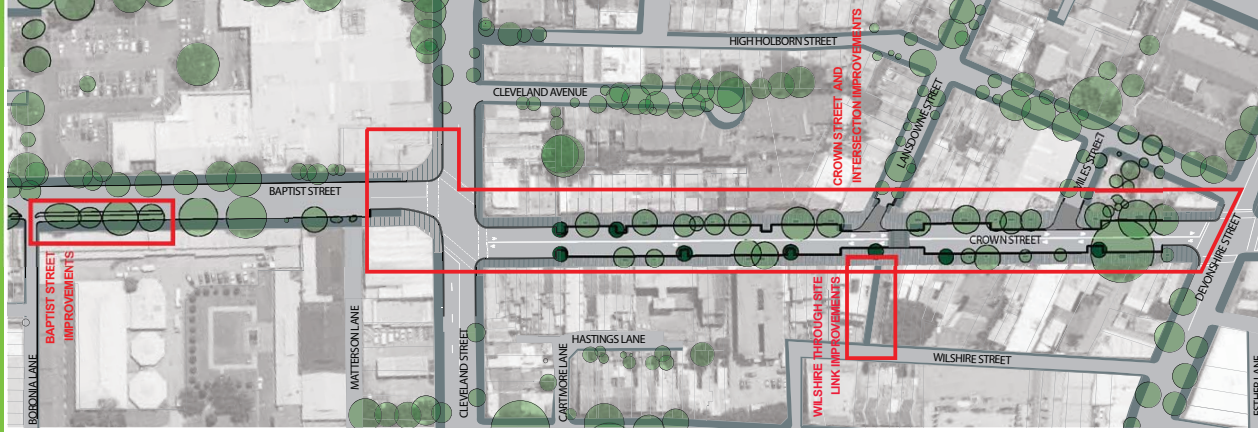

CONTEXT PLAN N.T.15

HAVE YOUR SAY

We would love to hear your feedback.

Your comments will be considered in the next phase of the design and the proposal reported to Council for endorsement. The necessary approvals from the State Transit Authority and Roads and Maritime Services will then be sought to allow this project to begin.

You can view and download these design plans at:
<http://www.cityofsydney.nsw.gov.au/vision/on-exhibition/current-exhibitions>

Please submit your comments by 6pm, 2nd June 2013 to Adam Lander a alander@cityofsydney.nsw.gov.au or by post to:

The Chief Executive officer
Attn: Adam Lander
City of Sydney
GPO Box 1591
Sydney NSW 2001

MORE INFORMATION

Please contact Adam Lander community engagement coordinator on 9265 9333 or email alander@cityofsydney.nsw.gov.au

Drop In Session

Shannon Reserve, Crown Street, Surry Hills
Saturday 18th May, 2013 11am - 1pm

In case of wet weather the information session will be held in Surry Hills Library

PROJECT TIME LINE

Consultation Period
Design Development
Estimated tender for construction
Estimated Construction Time

13th May - 2nd June 2013
June - August 2013
September 2013 - January 2014
January - October 2014





LEGEND

- EXISTING KERB LINE
- EXISTING APPROVED LICENSED OUTDOOR DINING AREA
- EXISTING TREE
- PROPOSED NEW SMART POLE STREET LIGHTING
- PROPOSED CONCRETE UNIT PAVING
- PROPOSED NEW TREE
- NEW GARDEN BED

LOCATION PLAN

Location plan map showing the project area highlighted in red. The map includes streets: BAPTIST ST, CLEVELAND ST, CROWN ST, LANSOWNE ST, DEVONSHIRE ST, and MILES ST. The project area is divided into SHEET 1, SHEET 2, SHEET 3, SHEET 4, and SHEET 5. A north arrow is located at the top right.

SCALE 1:200 @ A3

0 2 4 10

Crown Street

Streetscape Upgrade Montages



CROWN STREET EXISTING



PROPOSED CROWN STREET UPGRADE

Crown Street

Streetscape Upgrade Montage

Project / CoS Crown Street
COMMUNITY CONSULTATION / MAY 2013

city of villages



PROPOSED CROWN STREET UPGRADE

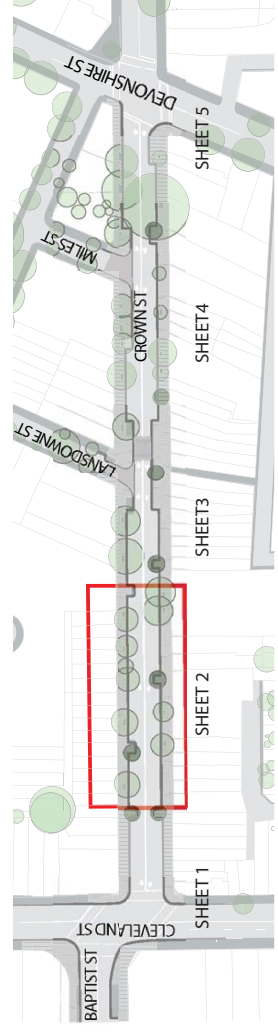

- LEGEND**
- EXISTING KERB LINE
 - EXISTING APPROVED LICENSED OUTDOOR DINING AREA
 - EXISTING TREE
 - PROPOSED NEW SMART POLE STREET LIGHTING
 - PROPOSED CONCRETE UNIT PAVING
 - PROPOSED NEW TREE
 - NEW GARDEN BED



LOCATION PLAN

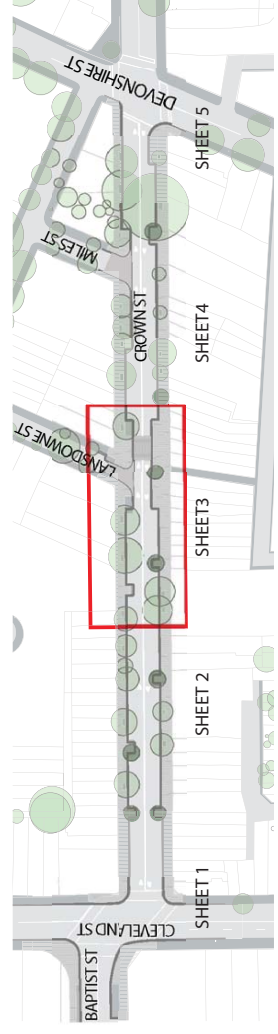

- LEGEND**
- EXISTING KERB LINE
 - EXISTING APPROVED LICENSED OUTDOOR DINING AREA
 - EXISTING TREE
 - RELOCATED BUS SHELTER
 - PROPOSED NEW SMART POLE STREET LIGHTING
 - PROPOSED CONCRETE UNIT PAVING
 - PROPOSED FOOTWAY CONTINUATION
 - PROPOSED RAISED PEDESTRIAN CROSSING
 - PROPOSED TREE
 - NEW GARDEN BED



LOCATION PLAN

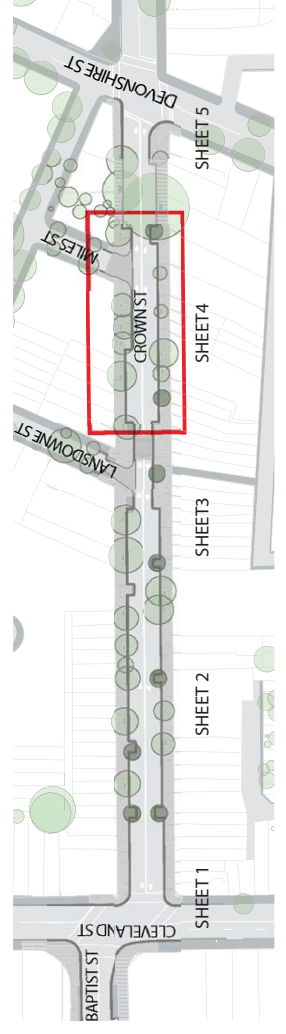
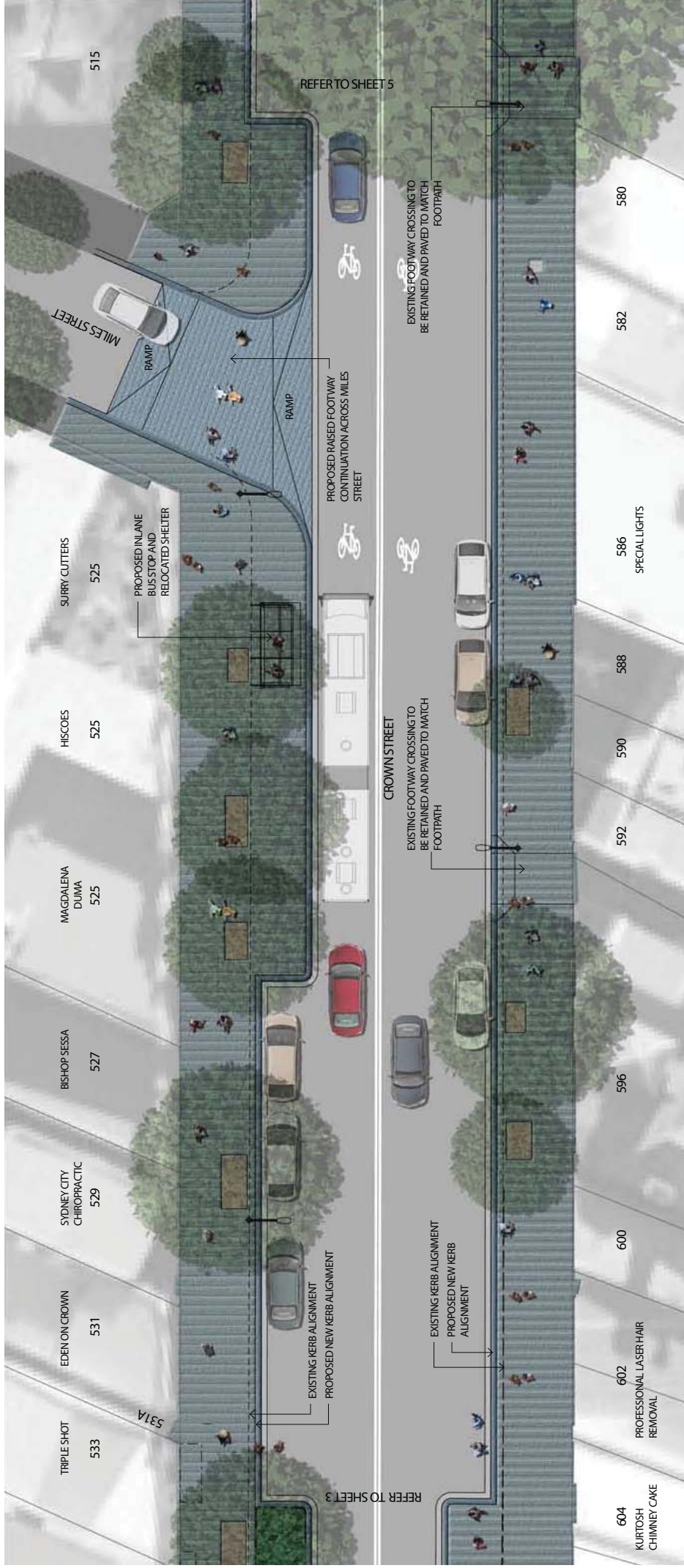

LEGEND

- EXISTING KERB LINE
- EXISTING TREE
- ▤ RELOCATED BUS SHELTER
- ⌨ PROPOSED NEW SMART POLE STREET LIGHTING
- ▨ PROPOSED CONCRETE UNIT PAVING
- ▩ PROPOSED FOOTWAY CONTINUATION
- ▧ PROPOSED RAISED PEDESTRIAN CROSSING
- PROPOSED TREE
- NEW GARDEN BED

SCALE 1:200 @ A3
0 2 4 10

N

LOCATION PLAN

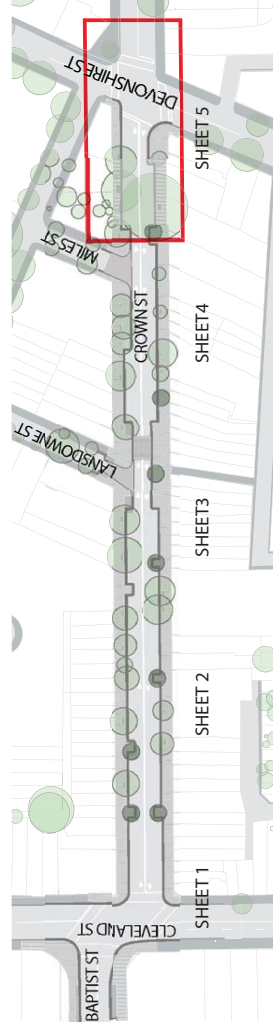

LEGEND

- EXISTING KERB LINE
- EXISTING TREE

- PROPOSED NEW SMART POLE STREET LIGHTING
- PROPOSED CONCRETE UNIT PAVING
- PROPOSED NEW TREE

SCALE 1:200 @ A3



LOCATION PLAN

Crown Street Streetscape Upgrade Montages



CROWN STREET EXISTING



PROPOSED CROWN STREET UPGRADE

Crown Street

Streetscape Upgrade Montage

Project / CoS Crown Street
COMMUNITY CONSULTATION / MAY 2013

city of villages



PROPOSED CROWN STREET UPGRADE

Baptist/Cleveland Street Intersection Streetscape Upgrade

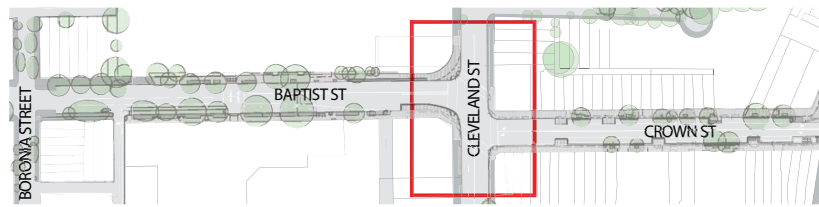
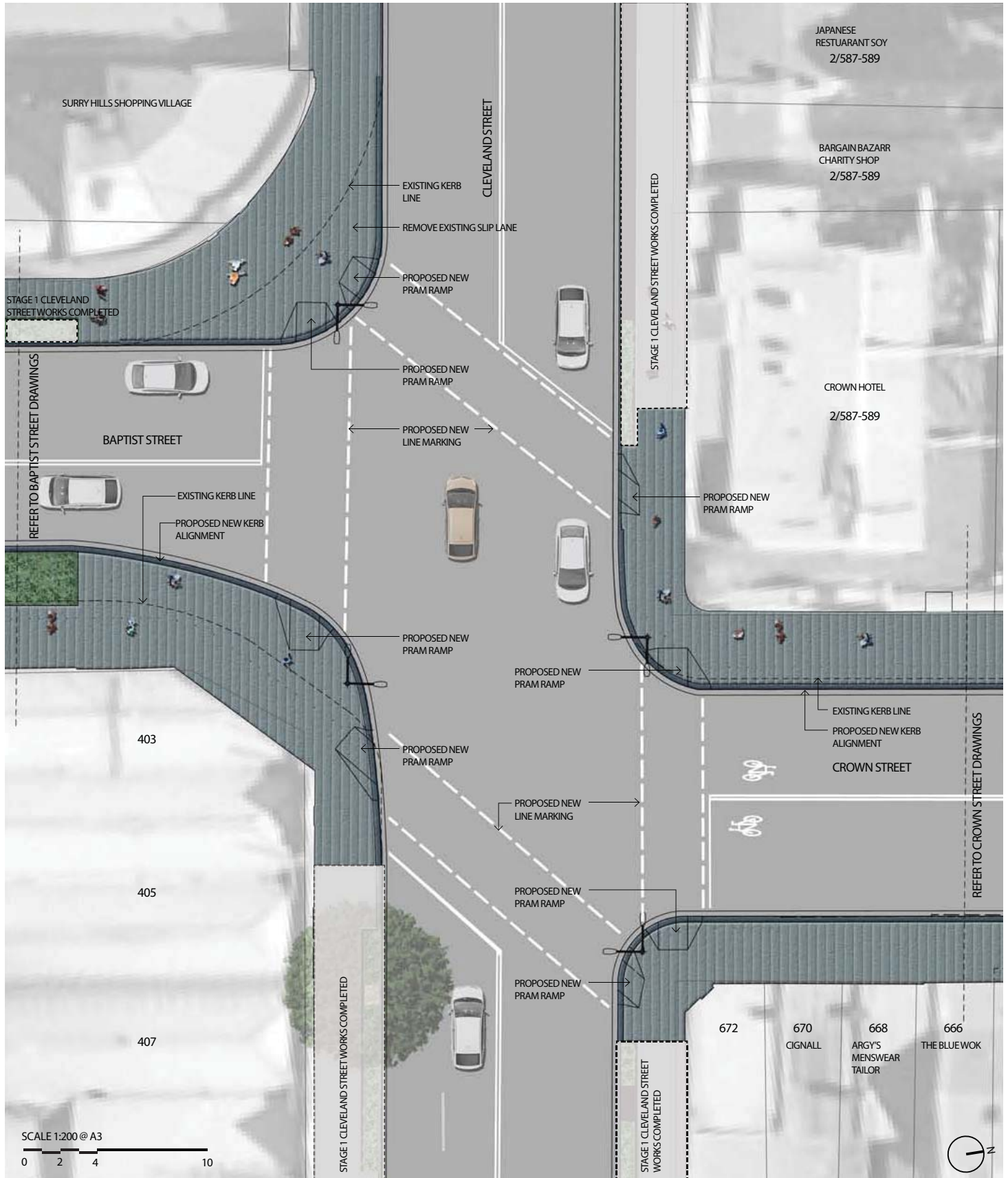

LOCATION PLAN

LEGEND

--- EXISTING KERB LINE

← PROPOSED SMART POLE STREET LIGHTING

■ PROPOSED CONCRETE UNIT PAVING



LEGEND

- EXISTING TREE & UPGRADED PIT
- PROPOSED BRICK PAVED FOOTPATH
- PROPOSED SEATS
- EXISTING GARDEN BED WITH NEW PLANTING AND MULCH

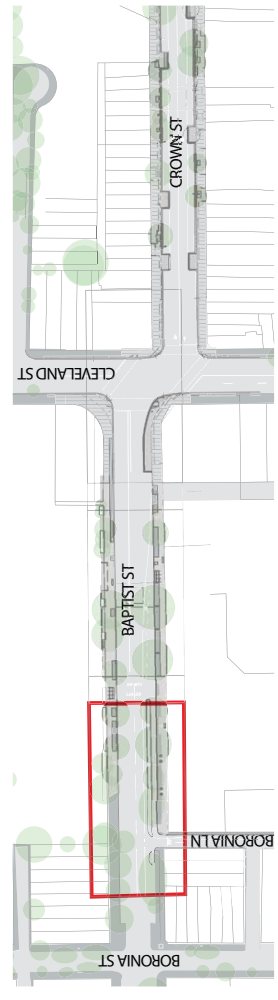

LOCATION PLAN



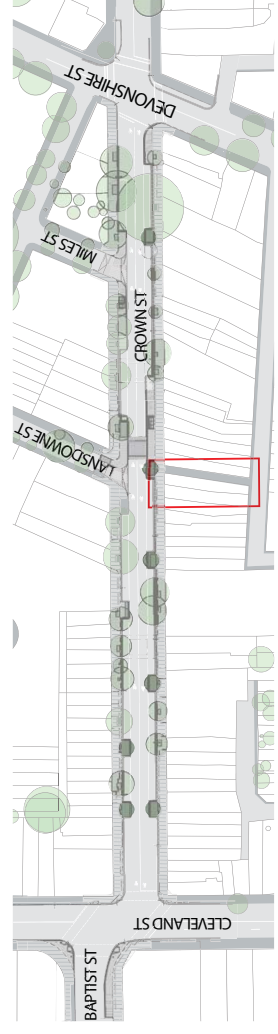
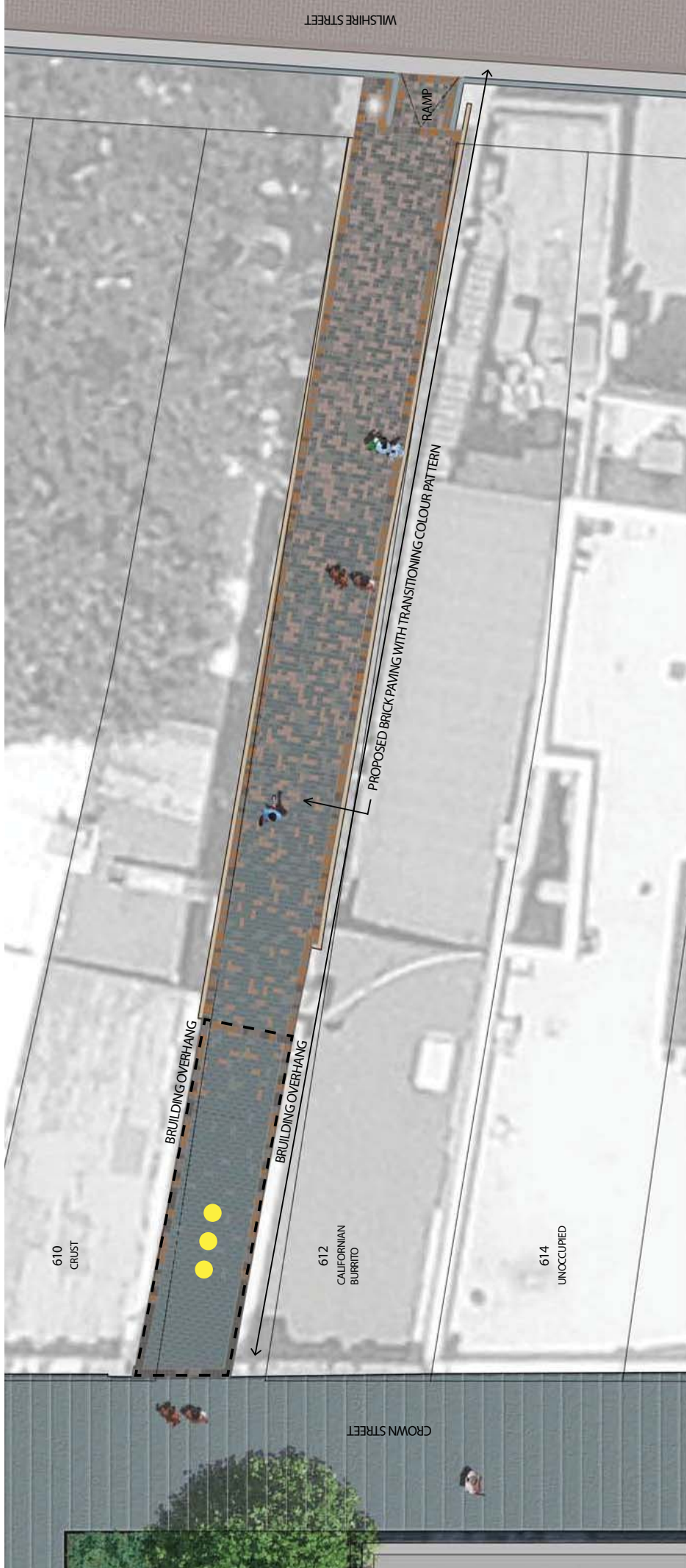

LOCATION PLAN

LEGEND

-  BUILDING OVER FOOTPATH
-  EXISTING WILSHIRE STREET PAVING
-  PROPOSED CONCRETE PAVING
-  PUBLIC ART - TO BE COMMISSIONED THROUGH OPEN EXPRESSION OF INTEREST



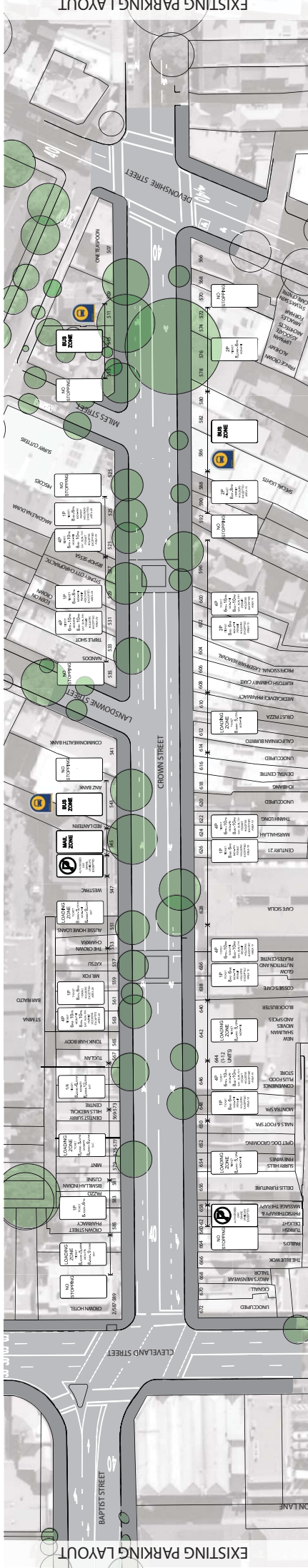

EXISTING PARKING LAYOUT

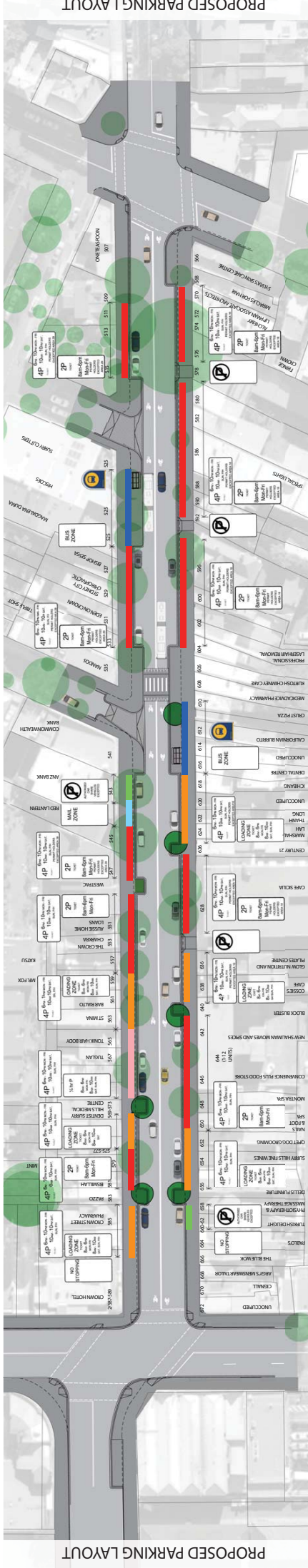

PROPOSED PARKING LAYOUT

LEGEND

- █ LOADING ZONES
- █ PROPOSED 2P - 4P PARKING ZONES
- █ PROPOSED 1/4P - 4P PARKING ZONES
- █ PROPOSED BUS ZONES
- █ CARE SHARE PARKING
- █ MAIL ZONE



SUMMARY OF PARKING CHANGES

LOADING ZONES

- six (6) ticketed loading zone locations retained
- some loading zone spaces reduced in size
- loading zone time restrictions extended to 8am - 6pm MON - FRI & 8am - 10pm SAT, SUN & Public Holidays

MAIL ZONES AND CAR SHARE SPACES

- two (2) car share spaces retained
- mail zone on western side relocated slightly north

PARKING SIGNAGE AND RESTRICTIONS

- ticketed parking retained
- standardisation of 2p and 4p parking restrictions
- permit holders exceptions retained
- parking spaces reduced from 45 to 43 between 8am and 6pm, Monday to Friday
- parking spaces reduced from 60 to 55 between 6pm and 8am Monday to Friday and on weekends

BUS ZONES AND BUS STOPS

- two (2) bus stops on western footpath consolidated into one (1)
- one (1) bus stop on eastern footpath relocated south